

**Archaeological Evaluation of Land Adjacent to Herne Court, Horn Street,
Folkestone, Kent, CT19 4QT**

Site Code: HCF-EV-17

NGR: NGR Site Centre: 619200 136850

Planning Application Number: Y16/0672/SH



Report for;

Alliance Building Contracts Ltd

13/09/2017

SWAT ARCHAEOLOGY

Swale and Thames Archaeological Survey Company

The Office, School Farm Oast, Graveney Road

Faversham, Kent ME13 8UP

Tel; 01795 532548 or 07885 700 112

info@swatarchaeology.co.uk www.swatarchaeology.co.uk

© SWAT Archaeology 2017 all rights reserved

Archaeological Evaluation of Land Adjacent to Herne Court, Horn Street, Folkestone, Kent, CT19 4QT

Contents

1	INTRODUCTION.....	5
1.1	Project Background.....	5
1.2	Site Description and Topography.....	5
2	ARCHAEOLOGICAL AND HISTORICAL BACKGROUND.....	6
2.1	Introduction.....	6
2.2	Archaeological Specification.....	6
3	AIMS AND OBJECTIVES	6
3.1	General Aims.....	6
4	METHODOLOGY	7
4.1	Introduction.....	7
4.2	Fieldwork.....	7
4.3	Recording	7
5	RESULTS	8
5.1	Introduction.....	8
5.2	Stratigraphic Deposit Sequence	8
5.3	Overview	8
6	FINDS.....	8
6.1	Overview	8
7	DISCUSSION.....	8
7.1	Archaeological Narrative	8
7.2	Conclusions.....	9
8	ARCHIVE.....	9
8.1	General	9

9	ACKNOWLEDGMENTS.....	9
10	REFERENCES	10
11	APPENDIX 1 – TRENCH TABLES	11
12	APPENDIX 2 - KCC HER FORM	12
13	APPENDIX 3 – SPECIFICATION (KCC 2017)	13

Figures

- Figure 1 Site location map
- Figure 2 Trench location
- Figure 3 Representative sections

Plates

- Plate 1 Evaluation trench, viewed from the south
- Plate 2 Representative Section #1
- Plate 3 Representative Section #2

Summary

Swale & Thames Survey Company (SWAT Archaeology) were commissioned by Alliance Building Contracts Ltd to undertake an archaeological evaluation on land within the western extent of the existing site. The archaeological works were monitored by the Kent County Council Principal Archaeological Officer.

The fieldwork was carried out in August 2017 in accordance with an archaeological specification (SWAT Archaeology 2017) submitted to, and approved by, KCC prior to commencement of works.

The Archaeological Evaluation consisted of one trench, which encountered a relatively common stratigraphic sequence comprising topsoil overlying subsoil which sealed an intact the natural geology. Despite the potential for archaeological remains and relatively good preservation conditions, no archaeological finds or features were recorded.

The results of this evaluation have been prepared to inform the decision for any further archaeological mitigation that may be required by the local planning authority and Kent County Council.

Archaeological Evaluation of Land Adjacent to Herne Court, Horn Street, Folkestone, Kent, CT19 4QT

NGR Site Centre: 619200 136850

Site Code: HCF-EV-17

1 INTRODUCTION

1.1 Project Background

1.1.1 Swale & Thames Survey Company (SWAT Archaeology) were commissioned by Alliance Building Contracts Ltd to undertake an archaeological evaluation on land adjacent to Herne Court, Horn Street, Folkestone, Kent (Figure 1).

1.1.2 A planning application (Y16/0672/SH) was submitted to Shepway District Council (SDC) for the erection of a three-storey block of six flats (6 x 1-bedroom units) together with parking and associated development. The Heritage & Conservation Department, who provide an archaeological advisory service to SDC, recommended that an archaeological investigation took place in advance of any development work. This recommendation was subsequently added as a Condition to the planning approval, which stated that;

No development shall take place until the applicant, or their agents, has secured the implementation of a programme of archaeological work in accordance with a written specification and timetable which has been submitted to and approved by the Local Planning Authority.

Reason: To ensure that features of archaeological interest are properly examined and recorded.

(Y16/0672/SH, Condition 7)

1.1.3 The fieldwork was carried out in August 2017 in accordance with an archaeological specification (Kent County Council 2017) submitted to SDC prior to commencement of works. A copy of the Specification is provided in Appendix 3.

1.2 Site Description and Topography

1.2.1 The site is centred on NGR 619200 136850, located directly south of the M20, west of Cheriton (Figure 1). The proposed development site consisted of an area formerly set out as a grass verge between Horn Street and Roman Way. The site is on flat ground at a level of approximately 63m above Ordnance Datum (aOD).

1.2.2 According to the British Geological Society, the underlying geology comprises sandstone of the Folkestone Formation.

2 ARCHAEOLOGICAL AND HISTORICAL BACKGROUND

2.1 Introduction

2.1.1 Further details of previous discoveries and investigations within the immediate and wider area may be found in the Kent County Council Historic Environment Record and have been summarised in the archaeological specification (KCC 2017: 5.1-5.3)

2.2 Archaeological Specification

2.2.1 The archaeological record for the site indicates that there are no designated heritage assets on the site and none in the immediate vicinity of the site. The archaeological potential is highlighted in the Specification (KCC 2017), which concludes states that 'to the north-east of the application site a possible Late Neolithic burial as well as Late Iron Age occupation and a Romano-British cemetery are all recorded. To the south-west of the site recent archaeological investigations have revealed further evidence for Prehistoric and Romano-British activity and also extensive remains of Anglo-Saxon date' (2017: 5.2).

3 AIMS AND OBJECTIVES

3.1 General Aims

3.1.1 The aims of the archaeological fieldwork, as set out in the Specification (Appendix 3) were to determine the potential for archaeological remains within the proposed site (2017: 6.1). In addition, the objectives of the evaluation also included;

- to establish the presence or absence of any elements of the archaeological resource, both artefacts and ecofacts of archaeological interest across the area of the development;
- to ascertain the extent, depth below ground surface, depth of deposit if possible, character, date and quality of any such archaeological remains by limited sample excavation;
- to determine the state of preservation and importance of the archaeological resource, if present, and to assess the past impacts on the site and pay particular attention to the character, height/depth below ground level, condition, date and significance of any archaeological deposits;

Also,

- The opportunity will also be taken during the course of the evaluation to place and assess any archaeology revealed within the context of other recent archaeological investigations in the immediate area and within the setting of the local landscape and topography. Specific research questions that may be answered are to identify the archaeological anomalies highlighted by the recent geophysical survey. In general, the work is to ensure compliance

with the archaeological requirement from the Kent County Archaeologist that an archaeological evaluation take place as a pre-planning requirement, and to publish the results either on line, or through OASIS and/or in a local journal.

4 METHODOLOGY

4.1 Introduction

4.1.1 All fieldwork was conducted in accordance with the methodology set out in the KCC Specification and carried out in compliance with the standards outlined in the Chartered Institute for Archaeologists' Standards Guidance for Archaeological Evaluations (CifA 2014).

4.2 Fieldwork

4.2.1 A single trench proposed within the extents of the Site (Figure 2).

4.2.2 The trench was initially scanned for surface finds prior to excavation. Excavation was carried out using a 360° mechanical excavator fitted with a toothless ditching bucket, removing the overburden to the top of the first recognisable archaeological horizon, under the constant supervision of an experienced archaeologist.

4.2.3 Where appropriate the trench was hand-cleaned to reveal features in plan and carefully selected cross-sections through the features were excavated to enable sufficient information about form, development date and stratigraphic relationships to be recorded without prejudice to more extensive investigations, should these prove to be necessary. All archaeological work was carried out in accordance with KCC and CifA standards and guidance. A complete photographic record was maintained on site that included working shots; during mechanical excavation, following archaeological investigations and during back filling.

4.3 Recording

4.3.1 A complete drawn record of the evaluation trenches comprising both plans and sections, drawn to appropriate scales (1:20 for plans, 1:10 for sections) was undertaken. The plans and sections were annotated with coordinates and aOD heights.

4.3.2 Photographs were taken as appropriate providing a record of excavated features and deposits, along with images of the overall trench to illustrate their location and context. The record also includes images of the Site overall. The photographic record comprises digital photography. A photographic register of all photographs taken is contained within the project archive.

4.3.3 A single context recording system was used to record the deposits. A full list is presented in Appendix 1. Layers and fills are identified in this report thus (100), whilst the cut of the feature is

shown [100]. Context numbers were assigned to all deposits for recording purposes; these are used in the report.

4.4 Monitoring

4.4.1 A monitoring visit was carried out by the Archaeological Officer at KCC on the 10th August 2017.

5 RESULTS

5.1 Introduction

5.1.1 A single evaluation trench, measuring 20m in length and 1.6m in width was mechanically excavated under archaeological supervision.

5.2 Stratigraphic Deposit Sequence

5.2.1 A relatively consistent stratigraphic sequence was recorded across the majority of the Site comprising topsoil sealing an intact subsoil which overlay the natural geology.

5.2.2 The topsoil (001) generally consisted of friable dark grey brown silty clay, topped with grass, overlying the subsoil (003) which consisted of mid brown grey sandy silt. The natural geology comprised mid orange grey brown clay silt with occasional small fragments of sandstone (003).

5.2.3 Appendix 1 provides the stratigraphic sequence for the trench, which includes two representative sections, as shown on Figure 2 and Plates 2-3.

5.3 Overview

5.3.1 No archaeological features were recorded within the trench.

6 FINDS

6.1 Overview

6.1.1 No archaeological finds were retrieved during this evaluation.

7 DISCUSSION

7.1 Archaeological Narrative

7.1.1 Despite the potential for the presence and survival of archaeological remains no archaeological features were recorded within the evaluation trench.

7.1.2 The presence of subsoil would suggest that preservation levels are relatively high and that if archaeological remains were present then they would have suffered minimal disturbance.

7.1.3 No archaeological finds were present in the topsoil and subsoil layers, which would have provided an indication of settlement within the surrounding area.

7.2 Conclusions

7.2.1 The archaeological evaluation has been successful in fulfilling the primary aims and objectives of the Specification. Development proposals are unlikely to impact on archaeological remains. Further archaeological mitigation, should it be necessary, will need to be determined in consultation with the Kent County Council Archaeological Officer and local planning authority.

7.2.2 This evaluation has, therefore, assessed the archaeological potential of land intended for development. The results from this work will be used to aid and inform the Archaeological Officer (KCC) of any further archaeological mitigation measures that may be necessary in connection with any future development proposals.

8 ARCHIVE

8.1 General

8.1.1 The Site archive, which will include; paper records, photographic records, graphics and digital data, will be prepared following nationally recommended guidelines (SMA 1995; CIfA 2009; Brown 2011; ADS 2013).

8.1.2 All archive elements will be marked with the site/accession code, and a full index will be prepared. The physical archive comprises 1 file/document case of paper records & A4 graphics

9 ACKNOWLEDGMENTS

9.1.1 SWAT would like to thank Alliance Building Contracts Ltd for commissioning the project, in particular Mr Leo Griggs. Thanks are also extended to Ben Found, Archaeological Officer, Kent County Council, for his advice and assistance.

9.1.2 Tim Allen (MCIfA) supervised the archaeological fieldwork; illustrations were produced by Bartek Cichy. The report was prepared and collated by David Britchfield (MCIfA) and edited Dr. Paul Wilkinson (MCIfA).

10 REFERENCES

ADS 2013. Caring for Digital Data in Archaeology: a guide to good practice, Archaeology Data Service & Digital Antiquity Guides to Good Practice

Brown, D.H., 2011. Archaeological archives; a guide to best practice in creation, compilation, transfer and curation, Archaeological Archives Forum (revised edition)

Chartered Institute for Archaeologists, 2009, *Standard and Guidance for the creation, compilation, transfer and deposition of archaeological archives.*

Chartered Institute for Archaeologists, 2014, *Standard and guidance: for field evaluation.*

Chartered Institute for Archaeologists, 2014, *Standard and guidance for the creation, compilation, transfer and deposition of archaeological archives.*

Department of the Environment, 2010, *Planning for the Historic Environment*, Planning (PPS 5) HMSO.

English Heritage 2002. Environmental Archaeology; a guide to theory and practice of methods, from sampling and recovery to post-excavation, Swindon, Centre for Archaeology Guidelines

English Heritage, 2006, *Management of Research Projects in the Historic Environment (MoRPHE).*

Kent County Council, 2017, Specification for an archaeological evaluation of land adjacent to Herne Court, Horn Street, Folkestone, Kent, CT 4QT

SMA 1993. Selection, Retention and Dispersal of Archaeological Collections, Society of Museum Archaeologists

SMA 1995. Towards an Accessible Archaeological Archive, Society of Museum Archaeologists

11 APPENDIX 1 – TRENCH TABLES

Rep Sec 1 Dimensions: 20m x 1.6m			
Context	Description	Interpretation	Depth (m)
101	Dark grey brown silty clay with occasional rooting and small (<0.005m) rounded stones	Topsoil - Existing surface	0.00-0.25
102	Mid brown grey sandy silt with rare small (<0.005m) rounded stones	Subsoil	0.25-0.40
103	Mid orange grey brown clay silt with occasional small fragments of sandstone	Natural geology	0.40-0.62+

Rep Sec 2 Dimensions: 20m x 1.6m			
Context	Description	Interpretation	Depth (m)
101	Dark grey brown silty clay with occasional rooting and small (<0.005m) rounded stones	Topsoil - Existing surface	0.00-0.22
102	Mid brown grey sandy silt with rare small (<0.005m) rounded stones	Subsoil	0.22-0.39
103	Mid orange grey brown clay silt with occasional small fragments of sandstone	Natural geology	0.39-0.49+

12 APPENDIX 2 - KCC HER FORM

Site Name: Land Adjacent to Herne Court, Horn Street, Folkestone, Kent, CT19 4QT

SWAT Site Code: HCF-EV-17

Site Address: As above

Summary:

Swale & Thames Survey Company (SWAT Archaeology) were commissioned by Alliance Building Contracts Ltd to undertake an archaeological evaluation on land within the western extent of the existing site. The archaeological works were monitored by the Kent County Council Principal Archaeological Officer.

The fieldwork was carried out in August 2017 in accordance with an archaeological specification (SWAT Archaeology 2017) submitted to, and approved by, KCC prior to commencement of works.

The Archaeological Evaluation consisted of one trench, which encountered a relatively common stratigraphic sequence comprising topsoil overlying subsoil which sealed an intact the natural geology. Despite the potential for archaeological remains and relatively good preservation conditions, no archaeological finds or features were recorded.

The results of this evaluation have been prepared to inform the decision for any further archaeological mitigation that may be required by the local planning authority and Kent County Council.

District/Unitary: Shepway District Council

Period(s):

NGR (centre of site to eight figures) NGR 619200 136850

Type of Archaeological work: Archaeological Watching Brief

Date of recording: August 2017

Unit undertaking recording: Swale and Thames Survey Company (SWAT Archaeology)

Geology: Folkestone Formation

Title and author of accompanying report: SWAT Archaeology (2017) Archaeological Evaluation on Land Adjacent to Herne Court, Horn Street, Folkestone, Kent, CT19 4QT

Summary of fieldwork results (begin with earliest period first, add NGRs where appropriate)

See above

Location of archive/finds: SWAT. Archaeology. Graveney Rd, Faversham, Kent. ME13 8UP

Contact at Unit: Paul Wilkinson

Date: 13/09/2017

SITE SPECIFIC REQUIREMENTS

Specification for an archaeological evaluation of land adjacent to Herne Court, Horn Street, Folkestone, Kent CT19 4QT.

1. Summary:

- 1.1 This specification sets out the requirements for an archaeological evaluation of land adjacent to Herne Court, Horn Street, Folkestone. The evaluation will comprise the excavation of a single archaeological trial trench in accordance with the attached trench location plan. The results of the evaluation works will inform the scope of any further archaeological mitigation that may be required at the site. The works are being undertaken in response to proposals for the erection of a dwelling and creation of vehicular access and parking.

2. Site Location & Description:

- 2.1 The proposed development is to be located on land adjacent to Herne Court, Horn Street, Folkestone, Kent CT19 4QT (NGR 619200 136850 approximate site centre). The proposed development is located on an area of grass verge between Horn Street and Roman Way. The proposed block of flats is to be located within the grassed area adjacent to Herne Court. To west the site is bounded by Horn Street, to the north and east by Roman Way and to the south by Herne Court.

3. Planning Background & Nature of Development:

- 3.1 The site has planning permission for the “erection of a three storey block of six flats (6 x 1-bedroom units) together with parking and associated development”. The Local Planning Authority’s planning reference number for the proposal is Y16/0672/SH.

- 3.2 The Local Planning Authority has placed the following condition (7) on the planning consent:

7) No development shall take place until the applicant, or their agents, has secured the implementation of a programme of archaeological work in accordance with a written specification and timetable which has been submitted to and approved by the Local Planning Authority.

Reason: To ensure that features of archaeological interest are properly examined and recorded.

4. Geological & Topographical Background:

- 4.1 According the mapping of the British Geological Society the site, which is

located at an elevation of some 63m aOD, is located on bedrock comprising sandstone of the Folkestone Formation.

5. Archaeological & Historical Background Potential

- 5.1 The archaeological potential is based on the proximity of archaeological remains presently recorded in the HER.
- 5.2 The proposed development site lies in an area of multi-period archaeological potential based on past discoveries within the Horn Street area. To the north-east of the application site a possible Late Neolithic burial as well as Late Iron Age occupation and a Romano-British cemetery are all recorded. To the south-west of the site recent archaeological investigations have revealed further evidence for Prehistoric and Romano-British activity and also extensive remains of Anglo-Saxon date.
- 5.3 Further information on the above can be found in the County Historic Environment Record which is held at the Heritage Conservation Group, Environment & Waste, Invicta House, County Hall, Maidstone ME14 1XX.

6. Specific Aims of the Archaeological Work:

- 6.1 The aim of the evaluation work is to determine whether any significant archaeological remains survive on site. Assessment of the results should provide guidance on what mitigation measures would be appropriate. Such measures may, for example, include further detailed archaeological excavation prior to development and/or an archaeological watching brief during construction work. This specification sets out the requirements for trial trenching on the site only. Further mitigation measures will be subject to other documents or specifications which will need to be agreed with the Local Planning Authority.
- 6.2 The evaluation is thus to ascertain the extent, depth below ground surface, depth of deposit, character, significance and condition of any archaeological remains on site.

7. Methodology:

- 7.1 The general methodology for the archaeological evaluation is set out in Part B of this specification.
- 7.2 The archaeological evaluation will comprise the excavation of a single archaeological trial trench within the footprint of the proposed development. An indicative trench location plan is attached at the end of this specification. The proposed trench measures some 20m by 1.8m and is shown in pink on the attached indicative location plan.
- 7.3 The Archaeological Contractor should confirm the nature and location of any constraints on-site prior to the commencement of excavation and if necessary amend the trench location plan accordingly. Particular attention will be paid to

avoiding any services and/or trees that are to be retained or to avoid damage to the roots thereof. Any amendments to the trench design must be agreed in advance with the County Archaeologist and a revised trench plan submitted for approval.

7.3 Should significant remains be exposed it may be necessary to enlarge or extend the evaluation trench to allow for further investigation of any significant features or deposits that may be encountered.

7.4 Prior to the commencement of fieldwork the Archaeological Contractor shall agree with the developer, or their agent, any fencing required during the works and requirements for reinstatement at completion. The Archaeological Contractor shall ensure that arrangements are in place for appropriate reinstatement prior to the commencement of any excavations.

8. Site Recording:

8.1 Site recording should be undertaken in accordance with the methodology outlined in Part B of this specification.

9. Site Reporting and Archiving:

9.1 Site reporting and archiving should be undertaken in accordance with the methodology outlined in Part B of this specification.

9.2 A copy of the resulting report shall be offered to the Folkestone Research & Archaeological Group.

10. Monitoring:

10.1 Site monitoring should be arranged in accordance with the methodology outlined in Part B of this specification.

10.2 Prior to the commencement of fieldwork, following the completion and fieldwork and when submitting the report the Archaeological Contractor should complete and submit the relevant portions of the Fieldwork Notification Form (attached).

11. General:

11.1 Prepared by the Heritage Conservation Group, Kent County Council
November 2016

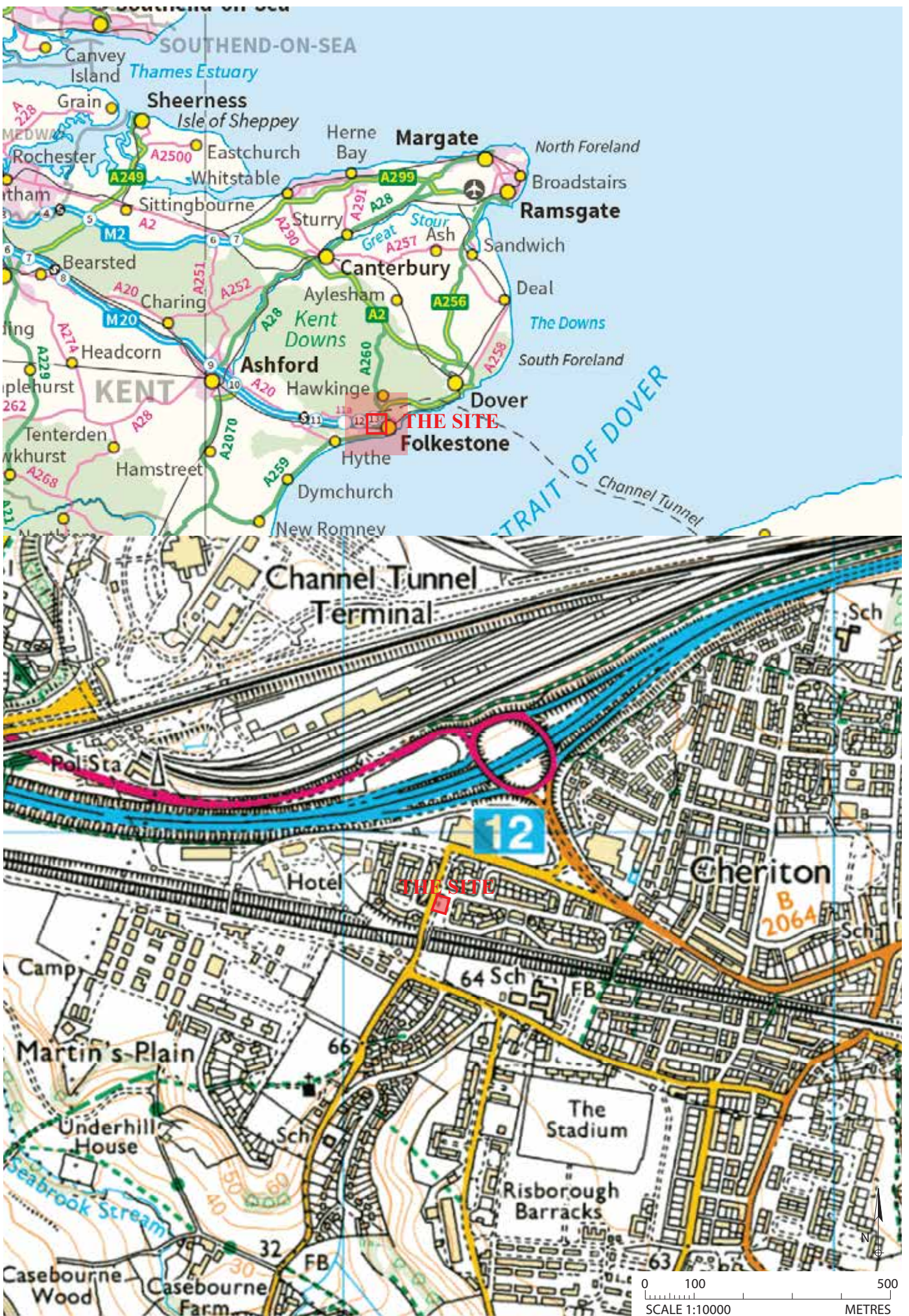

Figure 1: Site location map

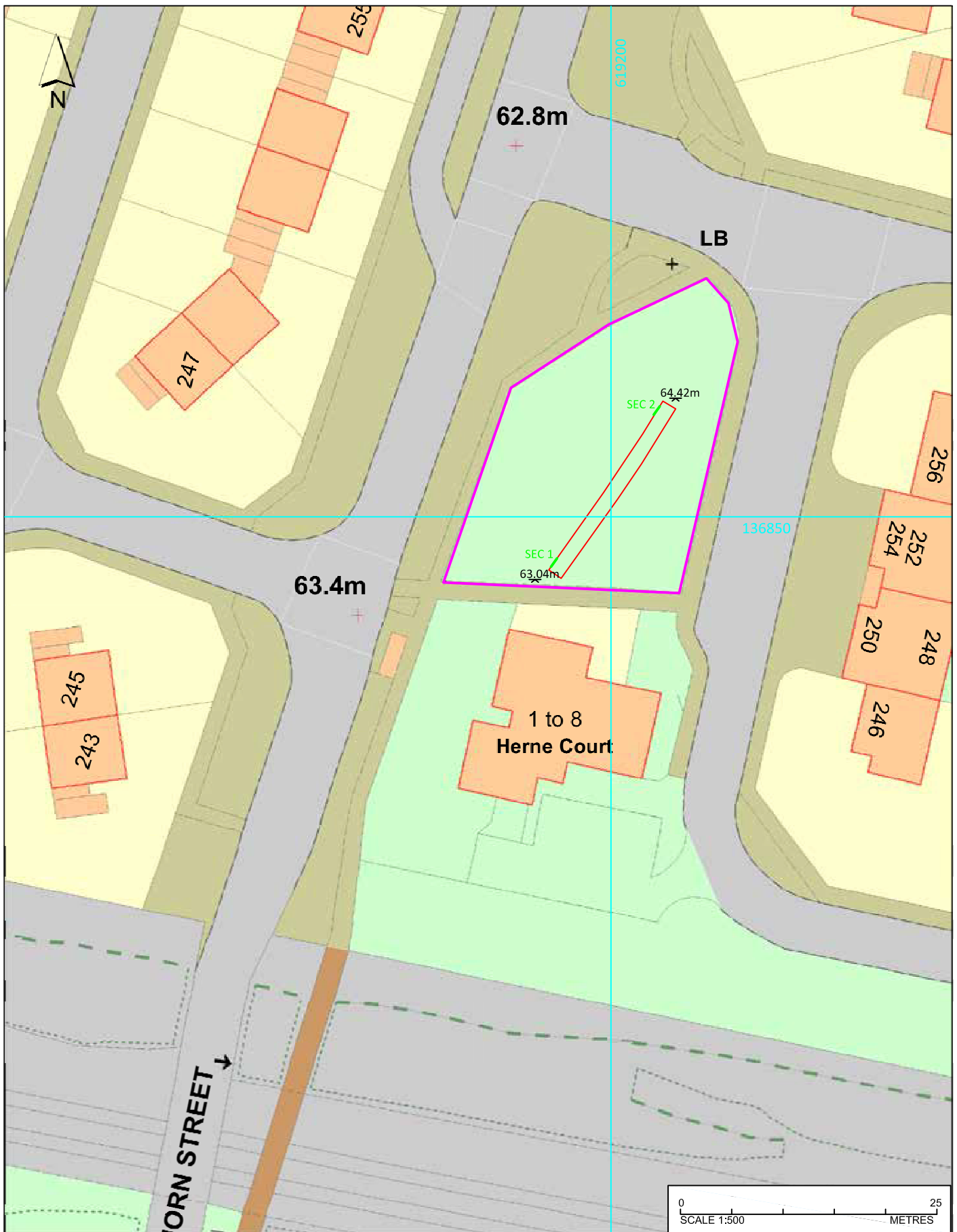
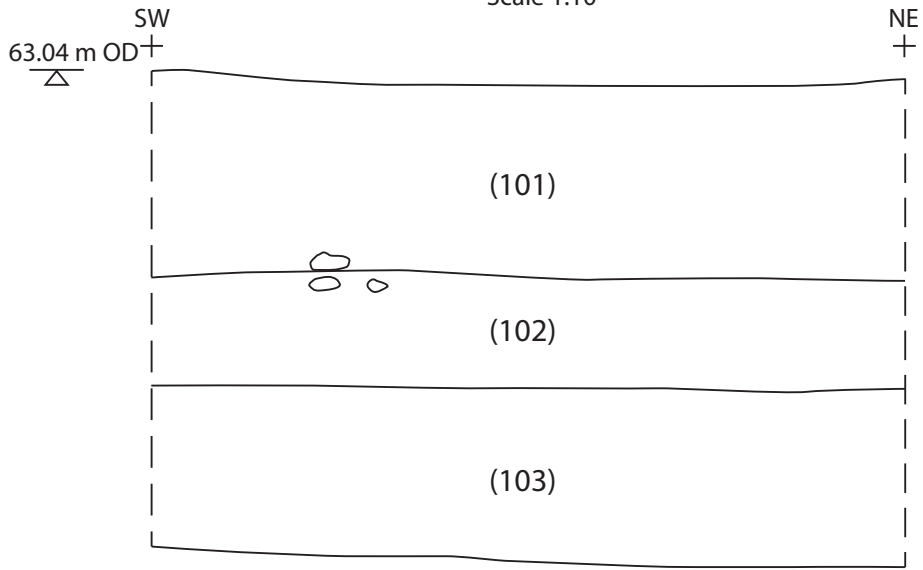

Figure 2: Trench location

Section 1

Located at the south end of the trench

Scale 1:10



Section 2

Located at the south end of the trench

Scale 1:10

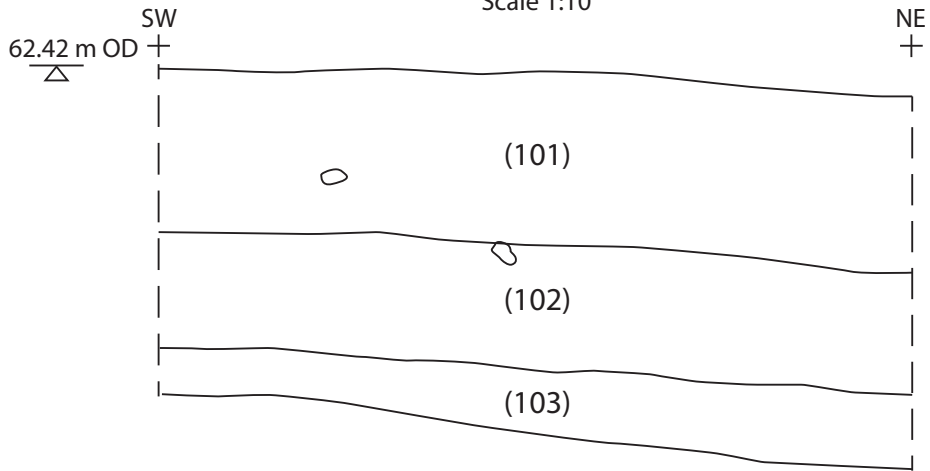

Figure 3: Representative sections



Plate 1 Evaluation trench viewed from the south



Plate 2 Representative Section #1



Plate 3 Representative Section #2